

Satellite S2S Installation Instructions

1. Place the Satellite S2S device in an area with a clear view of the sky in all directions.
2. Pull the magnet (red tab) out of the top of the unit to start locating. The magnet must remain removed from the device for it to continuously locate.

 The device needs a clear view of the sky. Areas denoted below in blue are TWM's recommended mounting locations for the S2S tracking device:

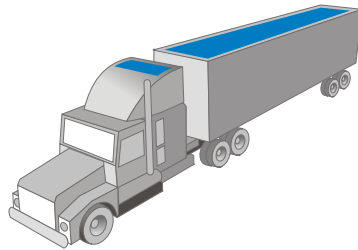
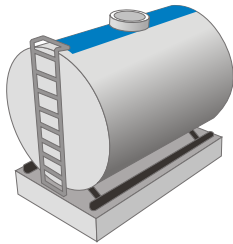

Tools Needed:

Phillips Screwdriver, Screws



 For more detailed installation information, including pictures, go to:
www.trackwhatmatters.com/install

 View your account at: app.trackwhatmatters.com